

LOCATION MAP
(NOT TO SCALE)

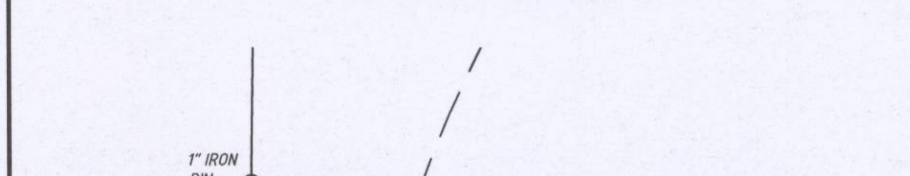

WELL PAD DETAIL

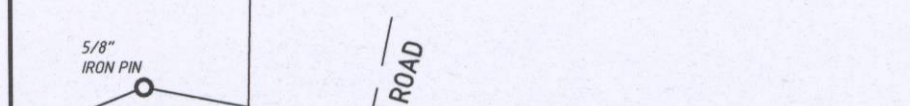

UNIT AREA
638.922 ACRES



UNIT PARCEL ACREAGE CHART

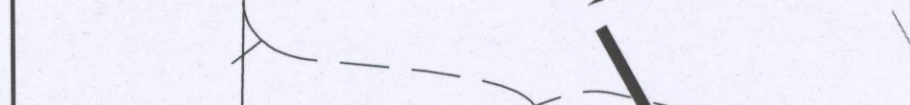

SURVEY PLAT SHOWING PROPOSED WELL

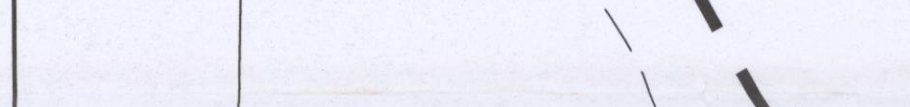

STATE OF OHIO, DEPARTMENT OF NATURAL RESOURCES - DIVISION OF OIL AND GAS RESOURCES MANAGEMENT, COLUMBUS, OHIO

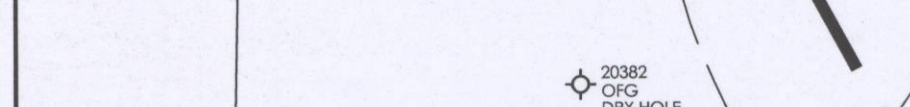

OPERATOR: AMERICAN ENERGY - UTICA, LLC



ADDRESS: 301 NW 63RD, SUITE 600, OKLAHOMA CITY, OK 73116

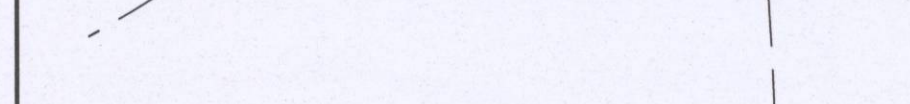

SURFACE LOCATION: DR. THOMAS PERKOWSKI, RANDY RABER, ERIC KIMBLE

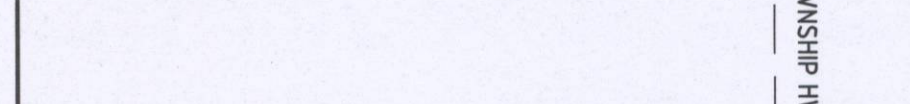

LANDOWNER: DR. THOMAS PERKOWSKI, RANDY RABER, ERIC KIMBLE

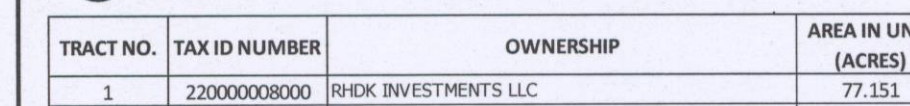

OIL AND GAS: DR. THOMAS PERKOWSKI, RANDY RABER, ERIC KIMBLE

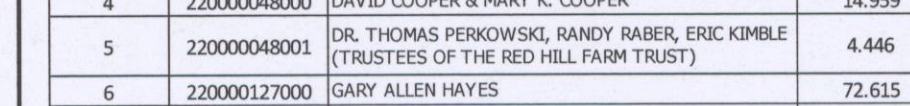

COAL: DR. THOMAS PERKOWSKI, RANDY RABER, ERIC KIMBLE

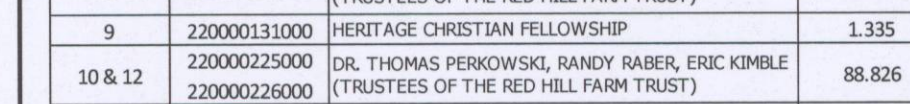

LEASE NAME: RED HILL FARM MDS GR

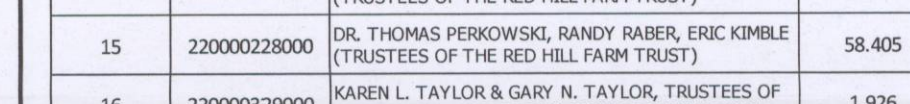

WELL NUMBER: 3H

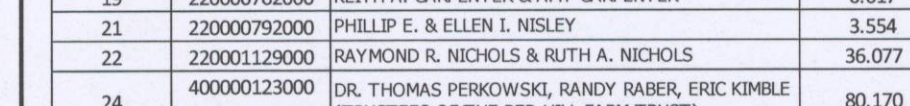

COUNTY: GUERNSEY

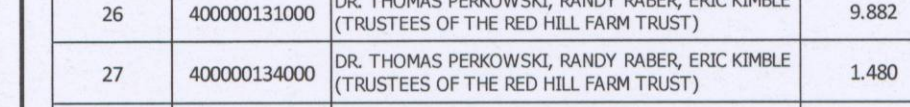

MUNICIPALITY: MADISON TWP

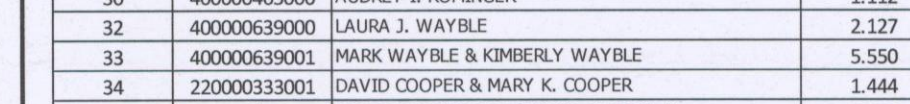

U.S.G.S. QUAD: FREEPORT

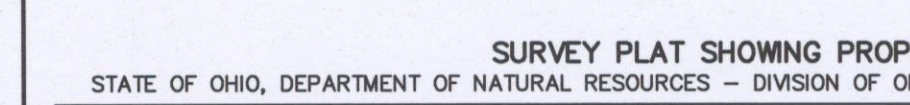

URBAN AREA: YES NO X

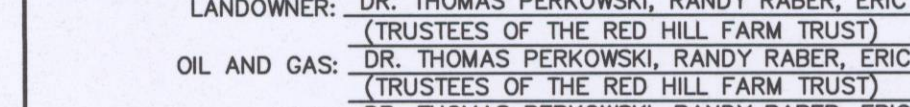

WELL TYPE: OIL OR GAS: X NEW LOCATION: X STRAT:

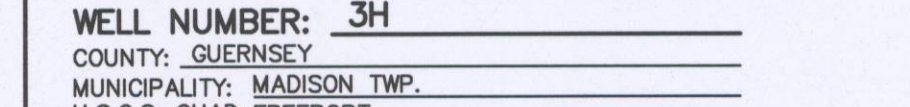

NOTES: 1. THIS SURVEY WAS PERFORMED SOLELY TO LOCATE THE PROPOSED WELL WITH RESPECT TO EXISTING BOUNDARIES AND TO PROVIDE STATE PLANE COORDINATES. 2. PARCEL BOUNDARIES AND MAP FEATURES SHOWN OUTSIDE OF THE UNIT WERE OBTAINED FROM THE COUNTY AUDITOR TAX MAPS AND/OR GIS DATA. CESO DOES NOT GUARANTEE THE ACCURACY OF THIS DATA. 3. THE UNIT BOUNDARY SHOWN IS INTENDED TO COMPLY WITH DIVISION OF OIL AND GAS RESOURCES MANAGEMENT SURVEY PLAT REQUIREMENTS IN ORDER TO IDENTIFY THE SET BACK DISTANCES. 4. PARCEL LINES, RIGHTS-OF-WAYS AND GEOGRAPHIC SUBDIVISION BOUNDARIES ARE BASED ON COUNTY GIS, DEED INFORMATION, AND FOUND MONUMENTATION. 5. THIS PLAT IS NOT A BOUNDARY SURVEY PURSUANT TO THE OHIO ADMINISTRATIVE CODE (OAC) 7433-37. 6. EXISTING DRILLING AND/OR PRODUCING WELLS AND ANY PLUGGED OIL OR GAS WELLS SHOWN WERE PLOTTED USING THE OADR OIL AND GAS INTERACTIVE WELL LOCATOR AND REPRESENT THE ACCURACY THEREOF, UNLESS OTHERWISE FIELD LOCATED.

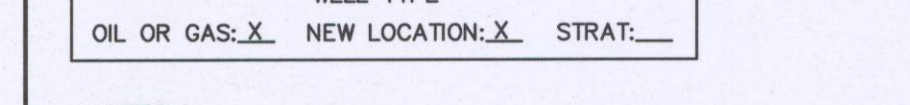

0 400' 800'

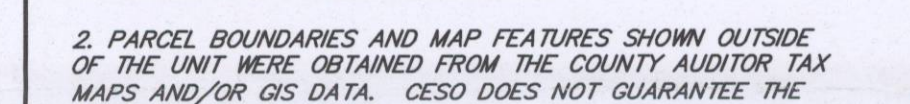

AMERICAN ENERGY
UTICA

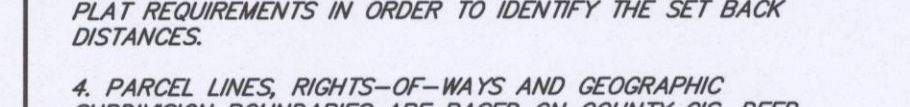

ceso

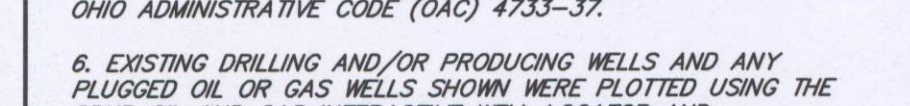

CREATION TO COMPLETION

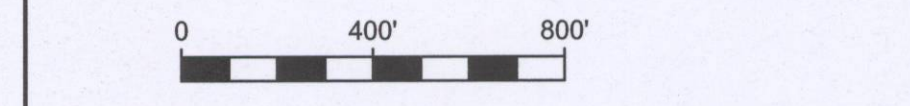

www.cesoinc.com



Engineering • Architecture • Survey • Construction Mgt • Environmental



1501 VANDERBILT STREET, DAYTON, OHIO 45408 (937) 455-5555



J. BRYANT APT OHIO P.S. #8593 ABT@CESOINC.COM



JUL 17, 2014



BRYANT APT S-8593

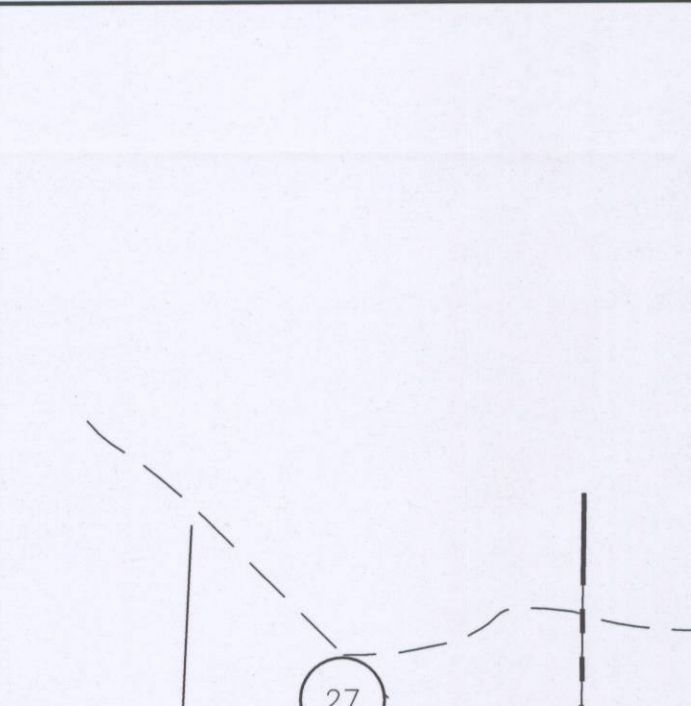

SURFACE HOLE

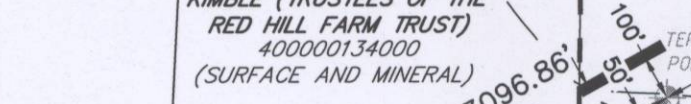

OHIO STATE PLANE GRID COORDINATE

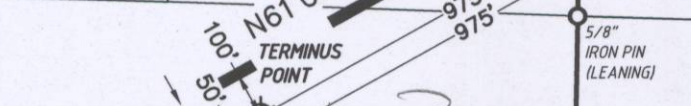

OHIO SOUTH - NAD 83(2011)

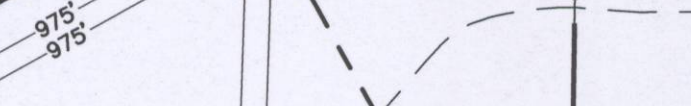

LATITUDE: 40.127542° N NAD 83

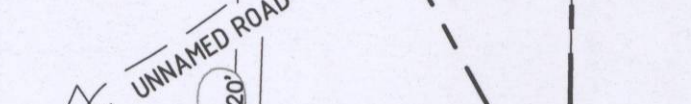

LONGITUDE: 81.345765° W NAD 83

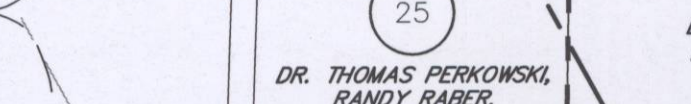

OHIO STATE PLANE GRID COORDINATE

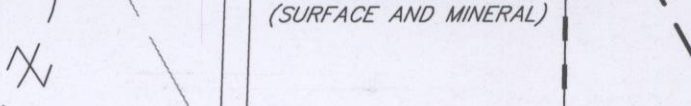

OHIO SOUTH - NAD 27

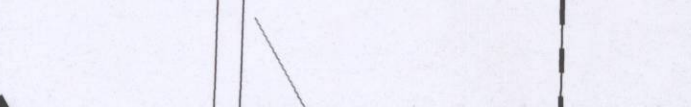

LATITUDE: 40.127472° N NAD 27

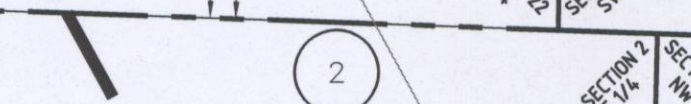

LONGITUDE: 81.345930° W NAD 27

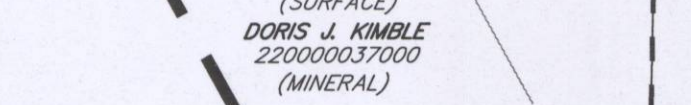

LAST PERFORATION



OHIO STATE PLANE GRID COORDINATE

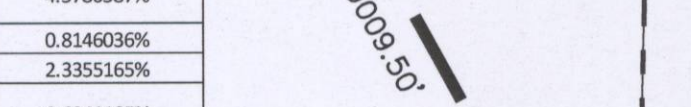

OHIO SOUTH - NAD 83(2011)

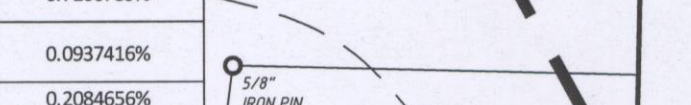

LATITUDE: 40.126978° N NAD 83

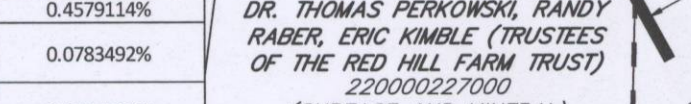

LONGITUDE: 81.347216° W NAD 83

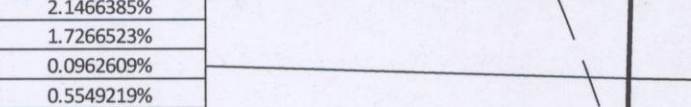

OHIO STATE PLANE GRID COORDINATE

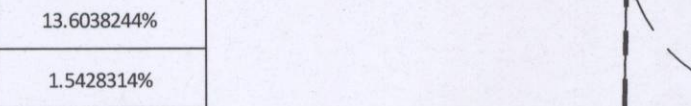

OHIO SOUTH - NAD 27



LATITUDE: 40.126908° N NAD 27

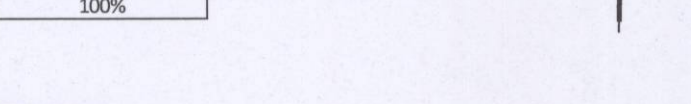

LONGITUDE: 81.347381° W NAD 27

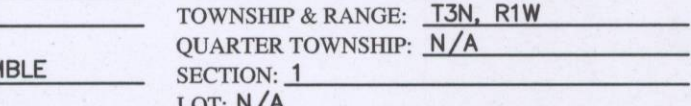

FIRST PERFORATION

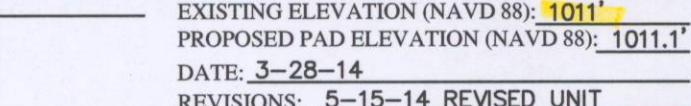

OHIO STATE PLANE GRID COORDINATE

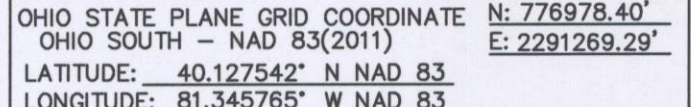

OHIO SOUTH - NAD 83(2011)

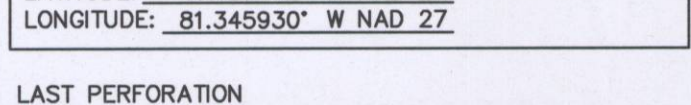

LATITUDE: 40.148081° N NAD 83

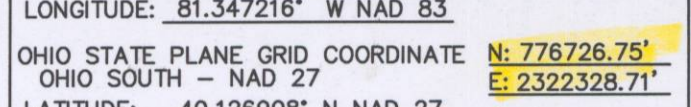

LONGITUDE: 81.361915° W NAD 83

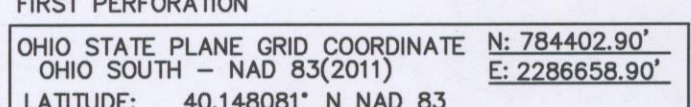

OHIO STATE PLANE GRID COORDINATE

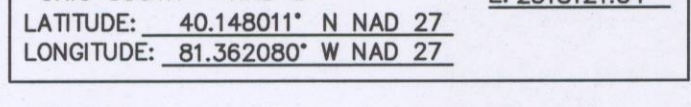

OHIO SOUTH - NAD 27

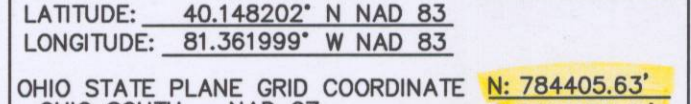

LATITUDE: 40.148132° N NAD 27



LONGITUDE: 81.362080° W NAD 27

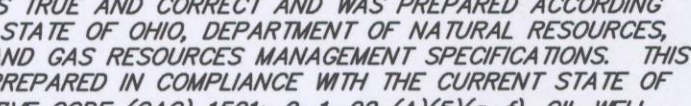

TERMINUS POINT

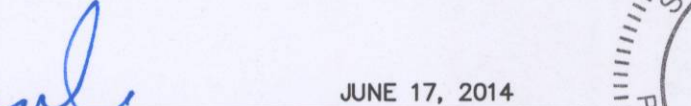

OHIO STATE PLANE GRID COORDINATE



OHIO SOUTH - NAD 83(2011)

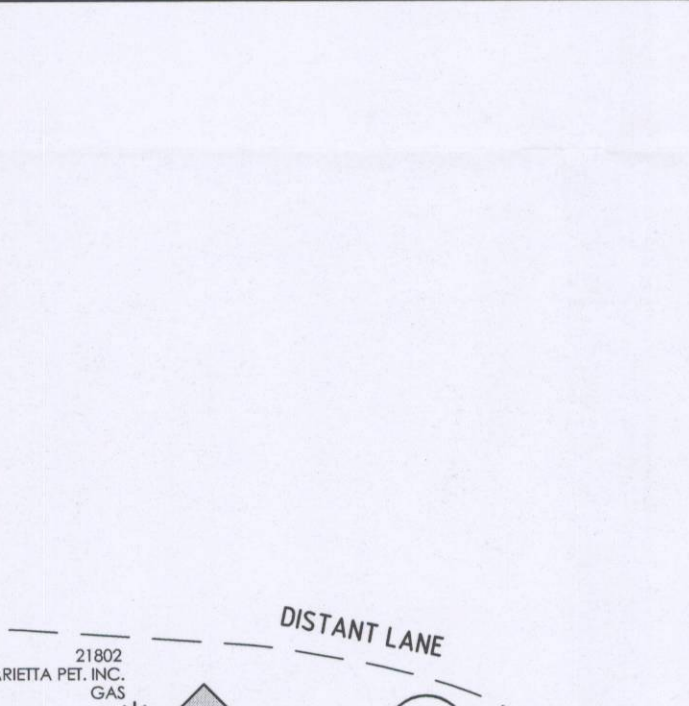

OHIO STATE PLANE GRID COORDINATE

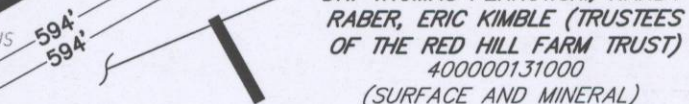

OHIO SOUTH - NAD 83(2011)

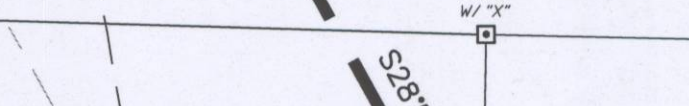

LATITUDE: 40.148081° N NAD 83



LONGITUDE: 81.361915° W NAD 83



OHIO STATE PLANE GRID COORDINATE

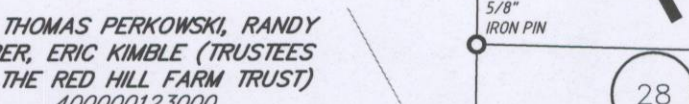

OHIO SOUTH - NAD 27



LATITUDE: 40.148132° N NAD 27

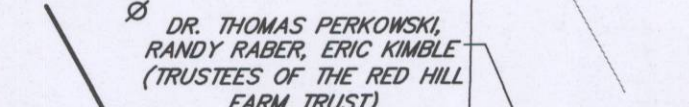

LONGITUDE: 81.362080° W NAD 27

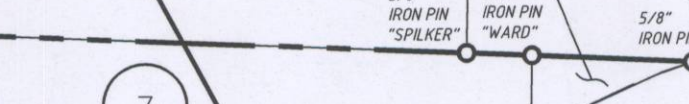

RECEIVED

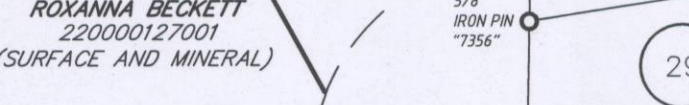

JUL 01 2014



DIVISION OF OIL AND GAS RESOURCES MANAGEMENT



UNIT CORNER COORDINATES:

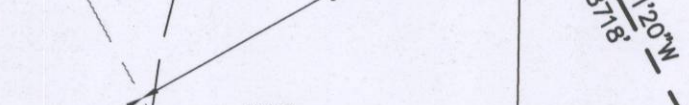

UNIT CORNER COORDINATES:



UNIT CORNER COORDINATES:

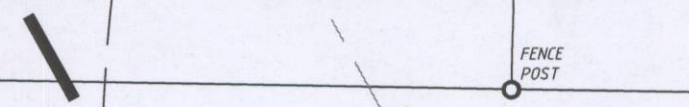

UNIT CORNER COORDINATES:



UNIT CORNER COORDINATES:



UNIT CORNER COORDINATES:



UNIT CORNER COORDINATES:

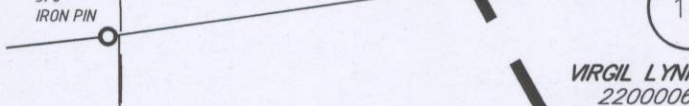

UNIT CORNER COORDINATES:

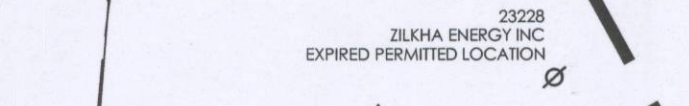

UNIT CORNER COORDINATES:

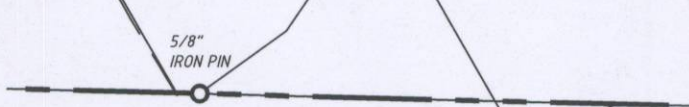

UNIT CORNER COORDINATES:

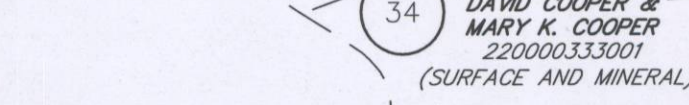

UNIT CORNER COORDINATES:

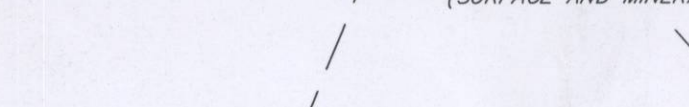

UNIT CORNER COORDINATES:

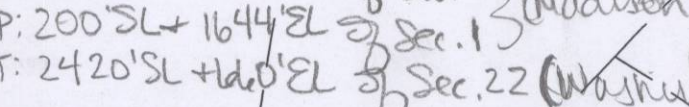

UNIT CORNER COORDINATES:

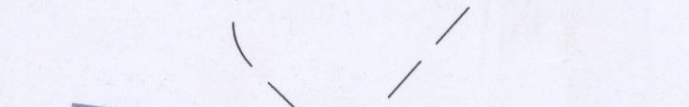

UNIT CORNER COORDINATES:

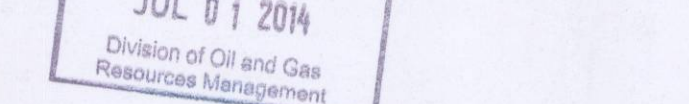

UNIT CORNER COORDINATES:

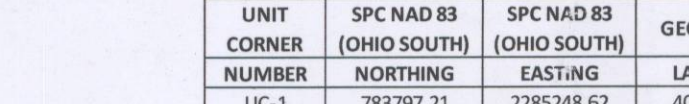

UNIT CORNER COORDINATES:

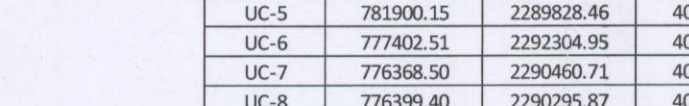

UNIT CORNER COORDINATES:

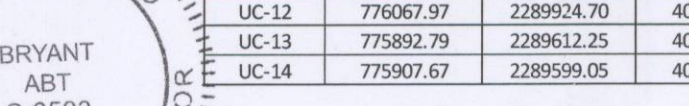

UNIT CORNER COORDINATES:



UNIT CORNER COORDINATES:

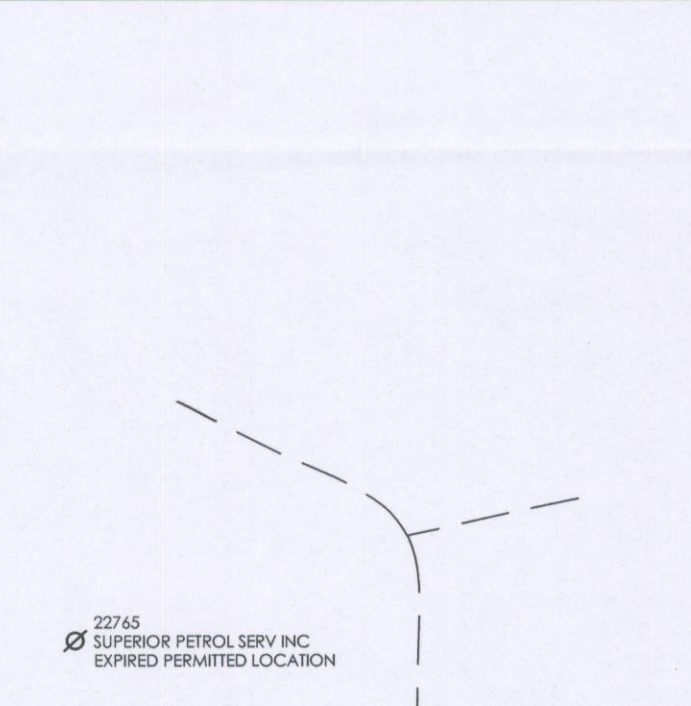

UNIT CORNER COORDINATES:



UNIT CORNER COORDINATES:

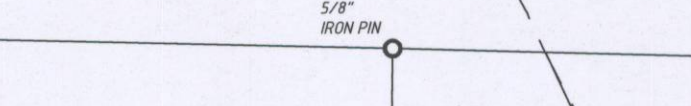

UNIT CORNER COORDINATES:

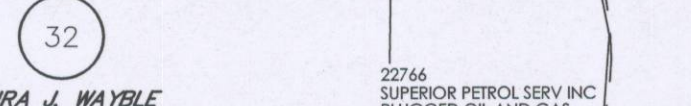

UNIT CORNER COORDINATES:

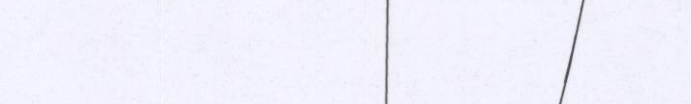

UNIT CORNER COORDINATES:



UNIT CORNER COORDINATES:



UNIT CORNER COORDINATES:



UNIT CORNER COORDINATES:



UNIT CORNER COORDINATES:



UNIT CORNER COORDINATES:

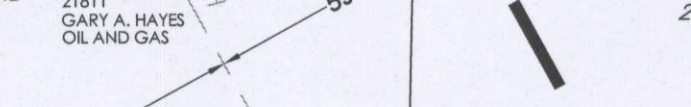

UNIT CORNER COORDINATES:

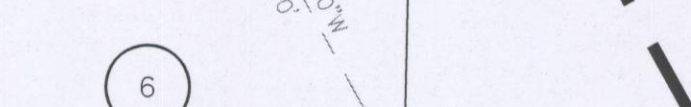

UNIT CORNER COORDINATES:



UNIT CORNER COORDINATES:



UNIT CORNER COORDINATES:

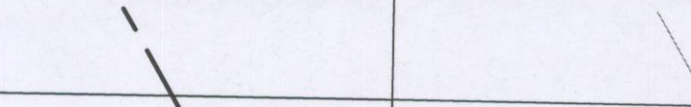

UNIT CORNER COORDINATES:

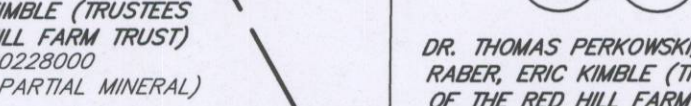

UNIT CORNER COORDINATES:

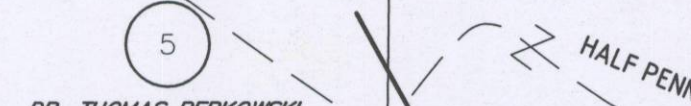

UNIT CORNER COORDINATES:

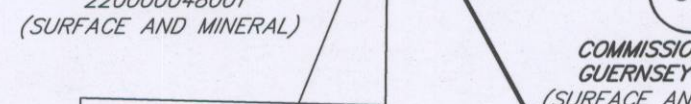

UNIT CORNER COORDINATES:

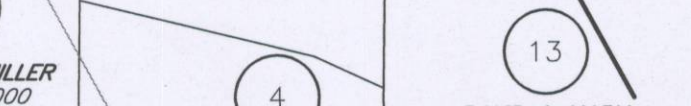

UNIT CORNER COORDINATES:

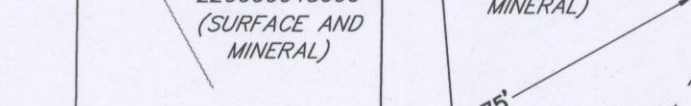

UNIT CORNER COORDINATES:



UNIT CORNER COORDINATES:



UNIT CORNER COORDINATES:

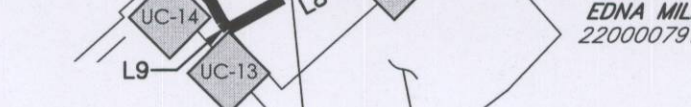

UNIT CORNER COORDINATES:

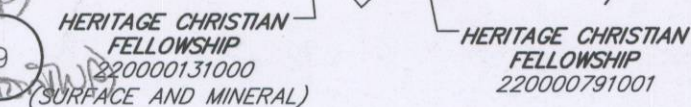

UNIT CORNER COORDINATES:



UNIT CORNER COORDINATES:



UNIT CORNER COORDINATES:

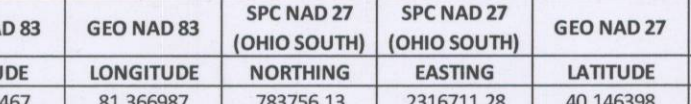

UNIT CORNER COORDINATES:

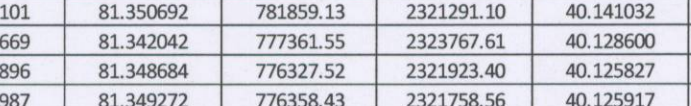

UNIT CORNER COORDINATES:

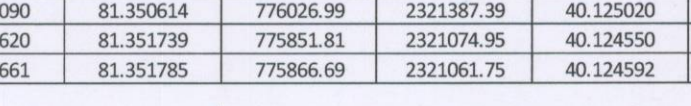

UNIT CORNER COORDINATES:

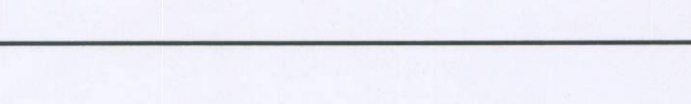

UNIT CORNER COORDINATES:

